

Adjacent Property zoned A-1

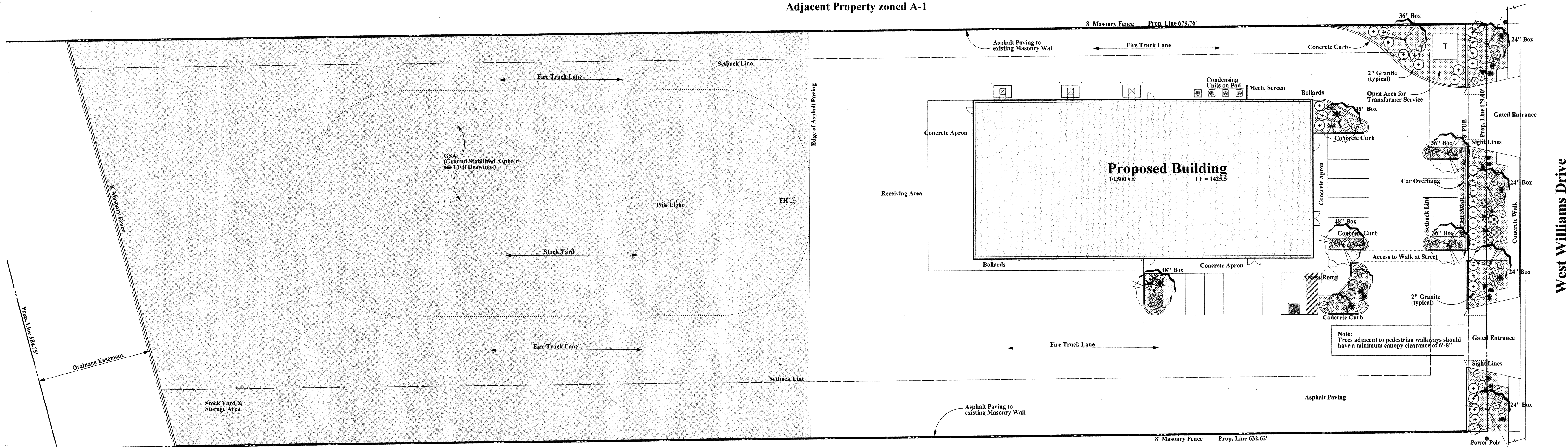

Adjacent Property zoned A-1

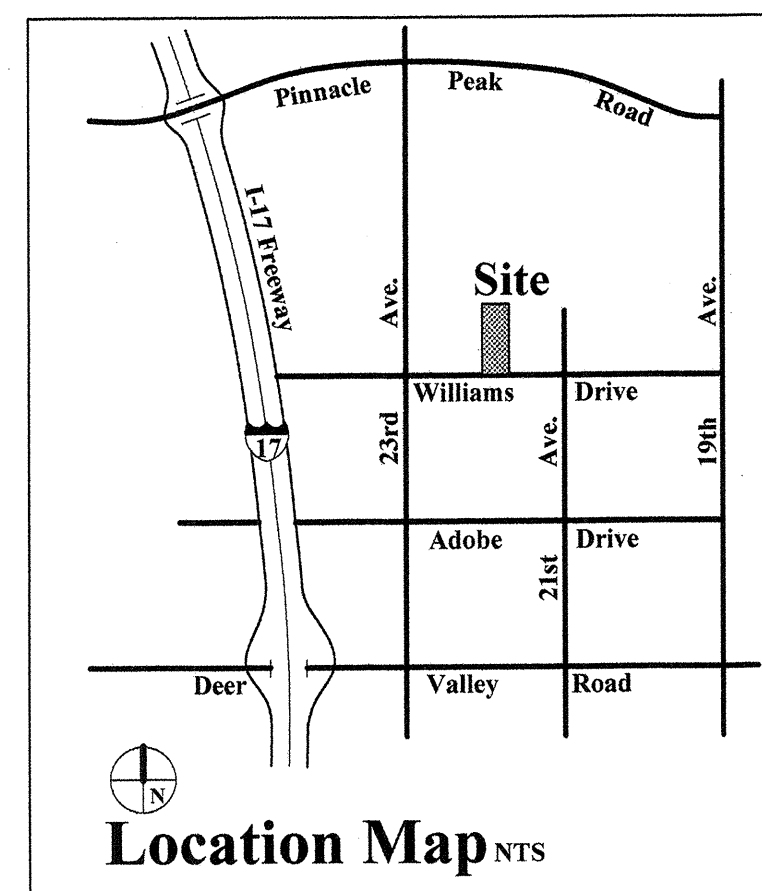

Project Zoning

Zoning District: A-1
 Open Space Landscape Area: 2,873 s.f.
 Parking Lot Landscape Area: 0 s.f.
 Right-of-Way Landscape Area: 943 s.f.
 Total Landscape Area: 3,816 s.f.

Turf Area Calculations

No Turf is proposed for Site

Existing Trees

No Trees exist on Site

Fireline BF Preventer

There is no fireline backflow preventor on this project.

Power Lines

No Power Lines exist on Site (Power Lines on adjacent Property but Lines do not cross Site)

Architectural Features

See Architectural Drawings for Details of Site Walls, Paving Surfaces etc.

City of Phoenix Notes:

- Final building permit cannot be obtained until bonding or approved assurances are provided for the landscaping within the right-of-way.
- No plant substitutions, type, size, or quantity deviations from the approved landscape or irrigation plans without prior approval from the City of Phoenix Landscape Section at 602-262-7811.
- All plant material and specifications to conform to the Arizona Nurseryman Association standards.
- All right-of-way and City-required (perimeter, retention, and parking) plant material to be in compliance with the Department of Water Resources low water use plant list.
- Verify ownership of any plant material or irrigation located in public right-of-way. Obtain permission from parks & Recreation Department (PRD) in writing, prior to removal of any City plant material or equipment. Contact 601-262-6862.
- All existing trees and shrubs in right-of-way designated to remain but are damaged or destroyed will be replaced in like size and kind by the contractor. Contact the Parks & Recreation Department prior to any right-of-way plant relocations at 602-252-6862.
- Existing City of Phoenix irrigation shall be modified in right-of-way and connected to the new system. Maintain any through irrigation requirements. Contractor cap off or abandon existing irrigation to plant material and provide new irrigation from project to existing right-of-way landscaping.
- All on-site accessible sidewalks shall be a minimum of 3 feet 0 inches wide and have a maximum slope of 1:20 with the maximum cross slope 1:50. All curbs must provide accessible ramps pursuant to the Americans with Disabilities Act (ADA) standards.
- Walls are not approved as part of this landscape plan but are shown for reference only.

Preliminary Planting Schedule

TREES	QUANTITY	SIZE	MINIMUM CALIPER
CAESALPINIA MEXICANA (multi-trunk)	2	24" box	2" caliper
CERCIDIUM PRAECOX (multi-trunk)	4	24" box	2" caliper
	3	36" box	3" caliper
	3	48" box	4" caliper
SHRUBS			
BOUGAINVILLEA 'Rosenka'	7	5 gallon	
RUELLIA PENINSULARIS	31	5 gallon	
TECOMA S. 'Orange Jubilee' (verify variety)	2	5 gallon	
ACCENTS			
AGAVE DESMETTIANA	6	5 gallon	
AGAVE GEMINIFLORA	16	5 gallon	
AGAVE VILMORINIANA	9	5 gallon	
HESPERALOE PARVIFLORA	3	5 gallon	
GROUND COVERS			
LANTANA 'New Gold' (verify variety)	45	1 gallon	
LANTANA 'New Gold' (verify variety)	18	5 gallon	
2" GRANITE COVERING	---	(1/2" screened) Madison Gold	3,816 s.f.
GSA	---	Ground Stabilized Asphalt (see Civil Drawings)	---

Note:
 Provide Documentation to Owner for all (*) Patented Plant Varieties installed in Project.

Site Retention:
 All Drainage will be directed to Drainage Easement at North End of Property. (See Civil Drawings for additional information).

Landscape Architect - City of Phoenix	Date
Estimated right-of-way Cost	\$3,750.00
Estimated s.f. of Landscape in R.O.W.	943 s.f.
Maintenance by:	Owner
	12 months Approval on Plans
Total acres (or portions) landscaped areas	3,816 s.f. (.087 acres)
Square Footage of Turf	0 s.f.
Date of Preliminary Site Plan Approval	18-Jan-07

ALL LANDSCAPE AREAS AND MATERIALS, INCLUDING THOSE LOCATED IN RIGHTS-OF-WAY, SHALL BE MAINTAINED IN A HEALTHY, NEAT, CLEAN, WEED FREE CONDITION. THIS SHALL BE THE RESPONSIBILITY OF THE PROPERTY OWNER

Two working days before you dig CALL FOR THE BLUE STAKES 602-283-1100 Blue Stake Center CALL COLLECT

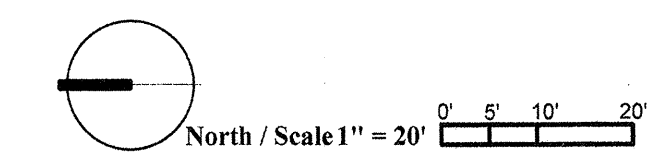
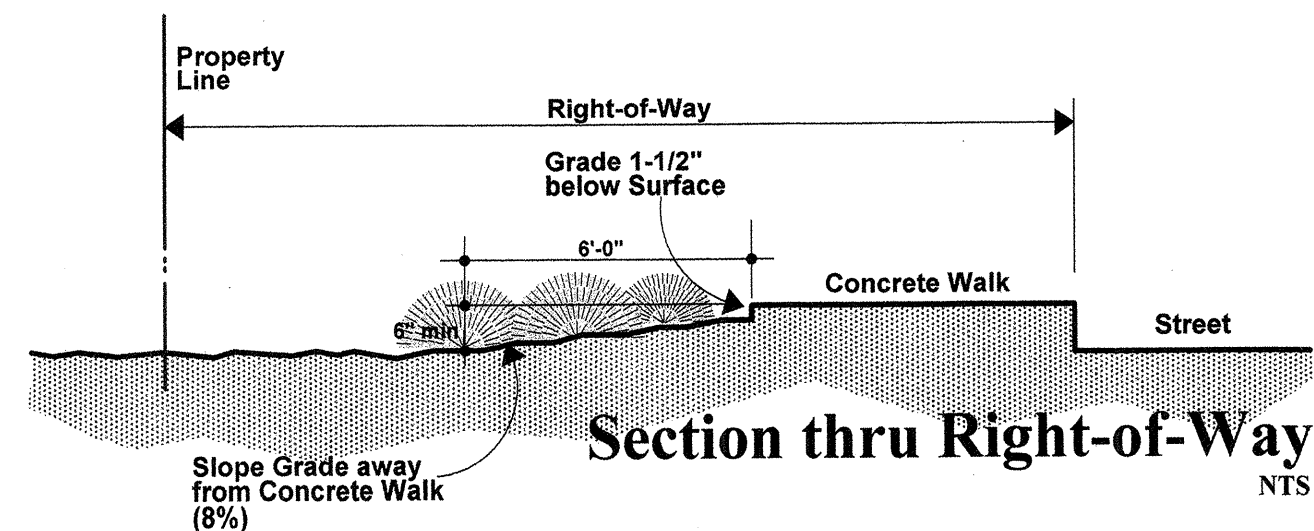

Planting Plan
 National Water Works

North Phoenix Branch #NWW5257
 2140 West Williams Drive
 Phoenix Arizona
 Prepared for Yellowknife Building Systems
 Contact Tom Porter 480-734-3457

Gordon Wayne Jones ASLA
 LANDSCAPE ARCHITECT
 1711 East Missouri Suite 7
 Phoenix Arizona 85016
 602-241-6111
 fax 602-776-9700

L1
 (of 3)
 Q.S.# 44-24
 KIVA #: 06-4203
 SDEV #: 0601286
 CCPR# 0700632

30 January 2007
 rev. 24 April 2007