



# THOMPSON PEAK COMMUNICATION TOWER

McDowell Mountain Park, Scottsdale, AZ.

City of Mesa

Project Number 02-410-001

SHEET INDEX	
SHEET NO.	TITLE
1	COVER SHEET
2	GENERAL CONSTRUCTION NOTES
3	GENERAL NOTES AND LEGEND
4	SITE SURVEY
5	SITE PLAN
6	HORIZONTAL CONTROL PLAN
7	GRADING PLAN
8	SOUTHWEST ELEVATION
9	GRADING CROSS SECTIONS
10	RETAINING WALL DETAILS
11	RETAINING WALL PLAN AND PROFILE
12	DETAILS
13	FENCE DETAILS
14	GROUNDING PLAN
15	ELECTRICAL DETAILS
16	TOWER (ROCK ANCHOR) FOUNDATION LAYOUT
17-22	TOWER PLANS
23-33	SHELTER PLANS

## VICINITY MAP

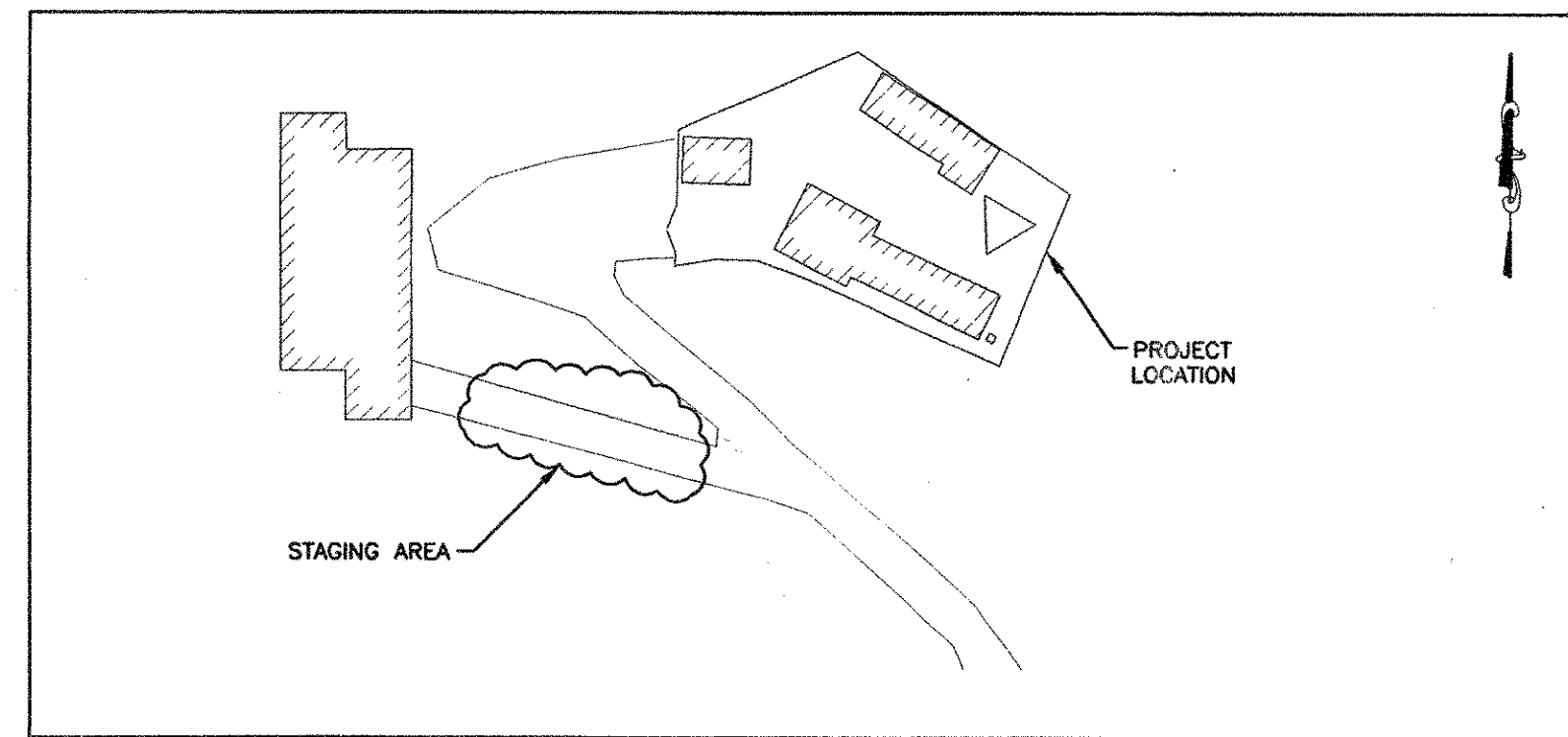

STAGING AREA #1

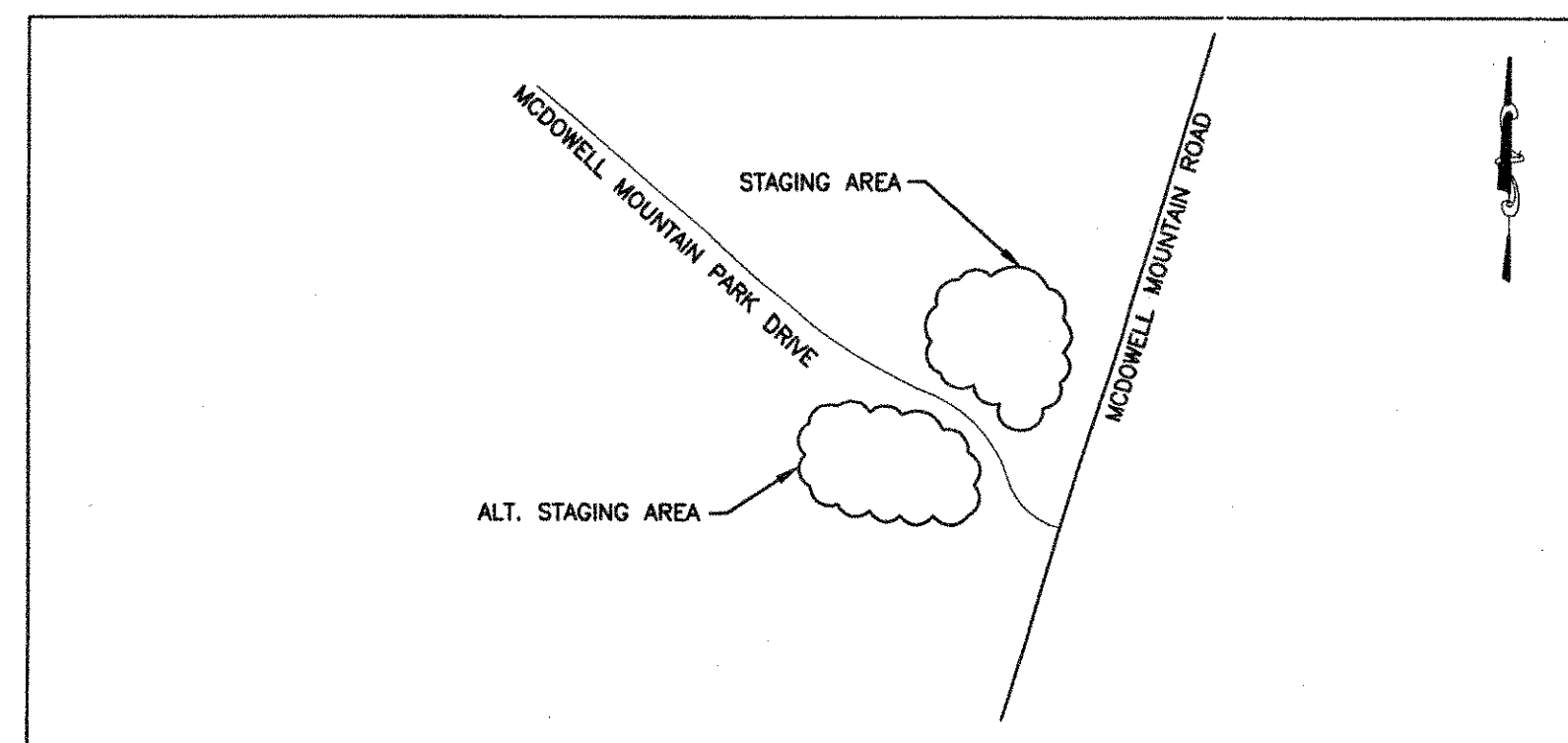

STAGING AREA #2  
(WITHIN MCDOWELL MOUNTAIN PARK)

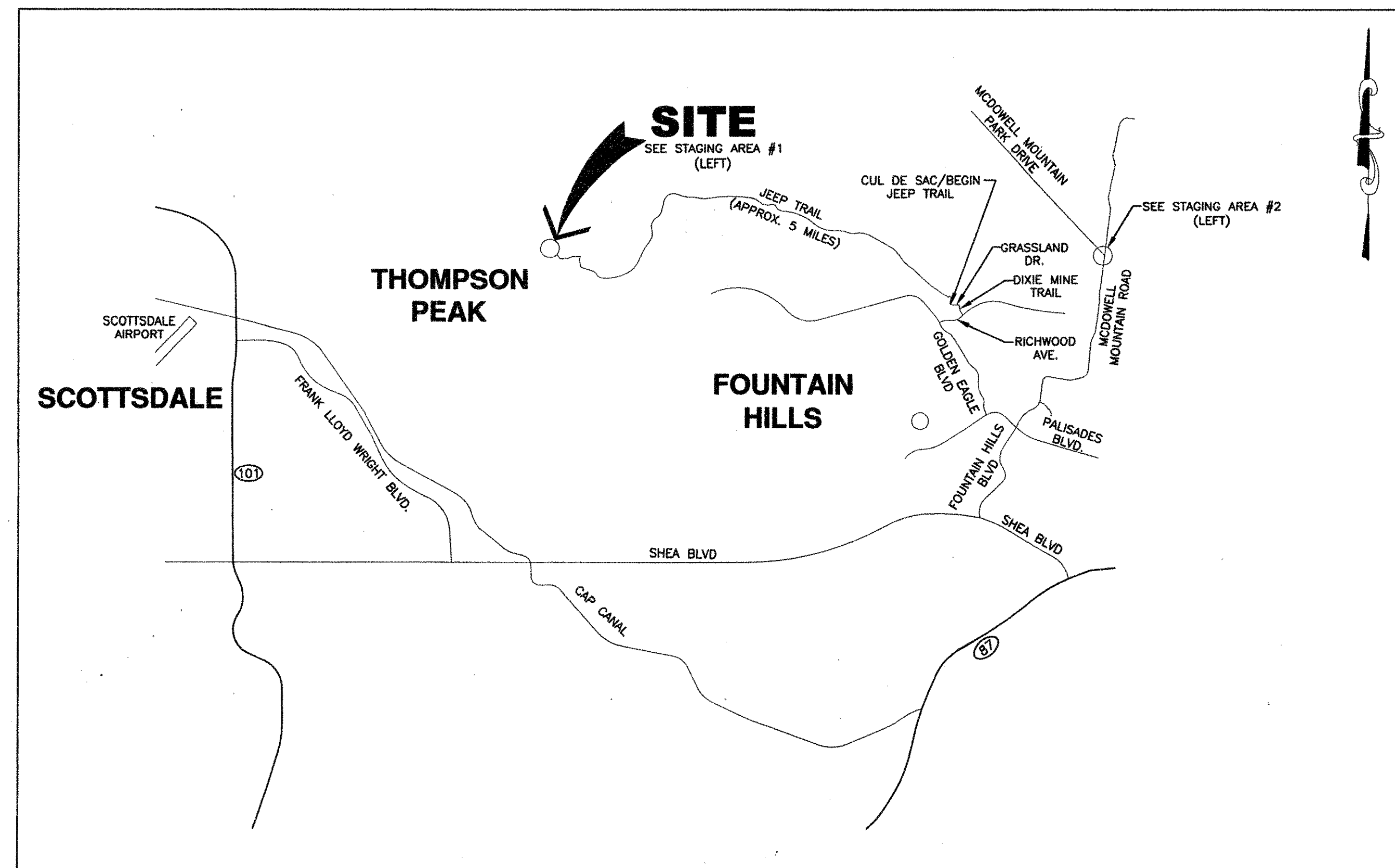

**APPROVED COPY**  
CITY OF MESA: ENGINEERING DEPARTMENT  
PLAN APPROVAL DOES NOT CONSTITUTE AN APPROVAL OR PERMIT FOR VIOLATION OF ANY PROVISIONS OF THE MAG UNIFORM STANDARD SPECIFICATIONS & DETAILS AS AMENDED BY THE CITY OF MESA.  
BY: *[Signature]* SEP 23 2010

## BENCHMARK

PK NAIL IN CONCRETE APPROX. 55'  
SOUTHWEST OF DPS SHELTER  
ELEVATION=3977.3' (NAVD88)  
SEE SITE SURVEY SHEET 4

 2151 EAST BROADWAY ROAD, SUITE 217, TEMPE, AZ 85282 VOICE: 480.905.8689 FAX: 480.905.8818	CITY OF MESA ENGINEERING DEPARTMENT	
	THOMPSON PEAK COMMUNICATION TOWER	
 DRAWN BY: BSH ENGINEER: SAM APPROVED BY: F RUSTAM	COVER SHEET	DRAWING 1
340 W.O. 4399 PROJ. NO. 02-410-001	1 OF 33	CATALOG NUMBER: A-139256